

© LaCour, Inc. All rights reserved. This document discloses confidential & proprietary technology that is the sole property of LaCour, Inc. Any unauthorized duplication, disclosure and/or distribution is prohibited.

# OPERATION SP-16 PEDS

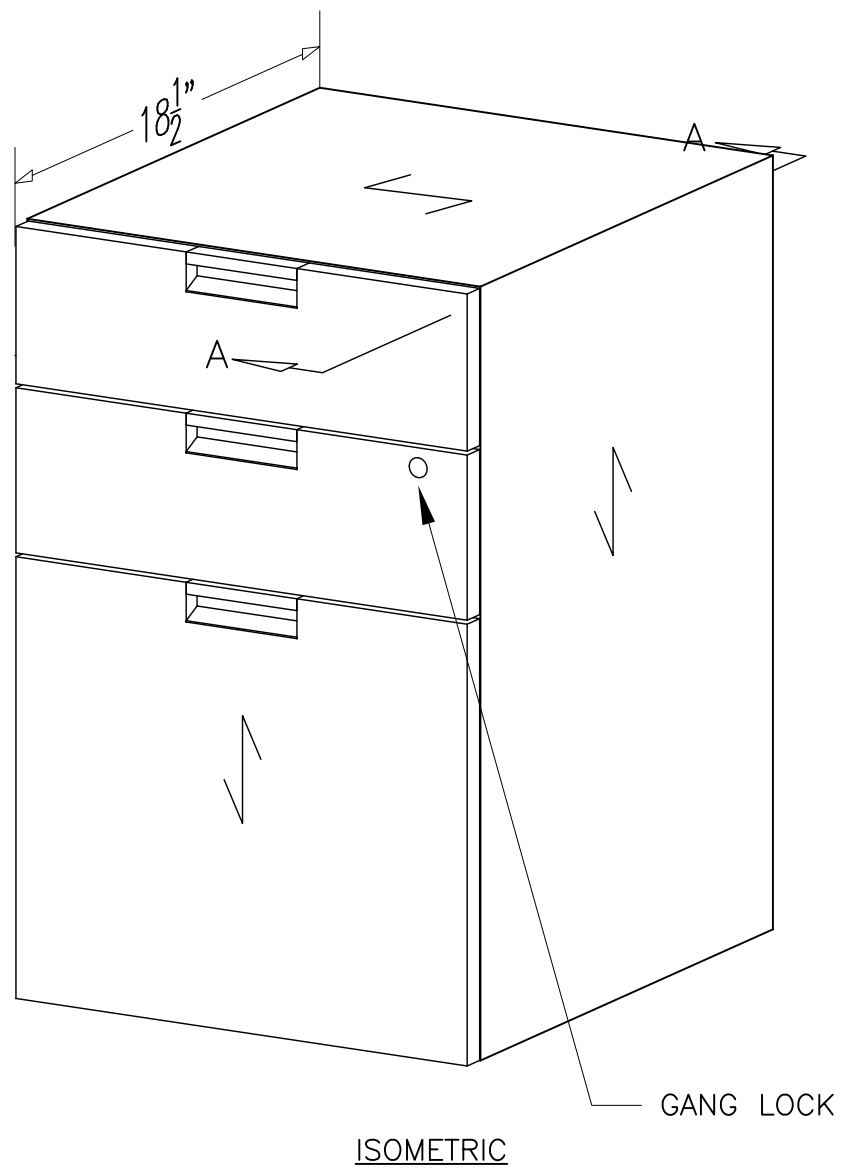
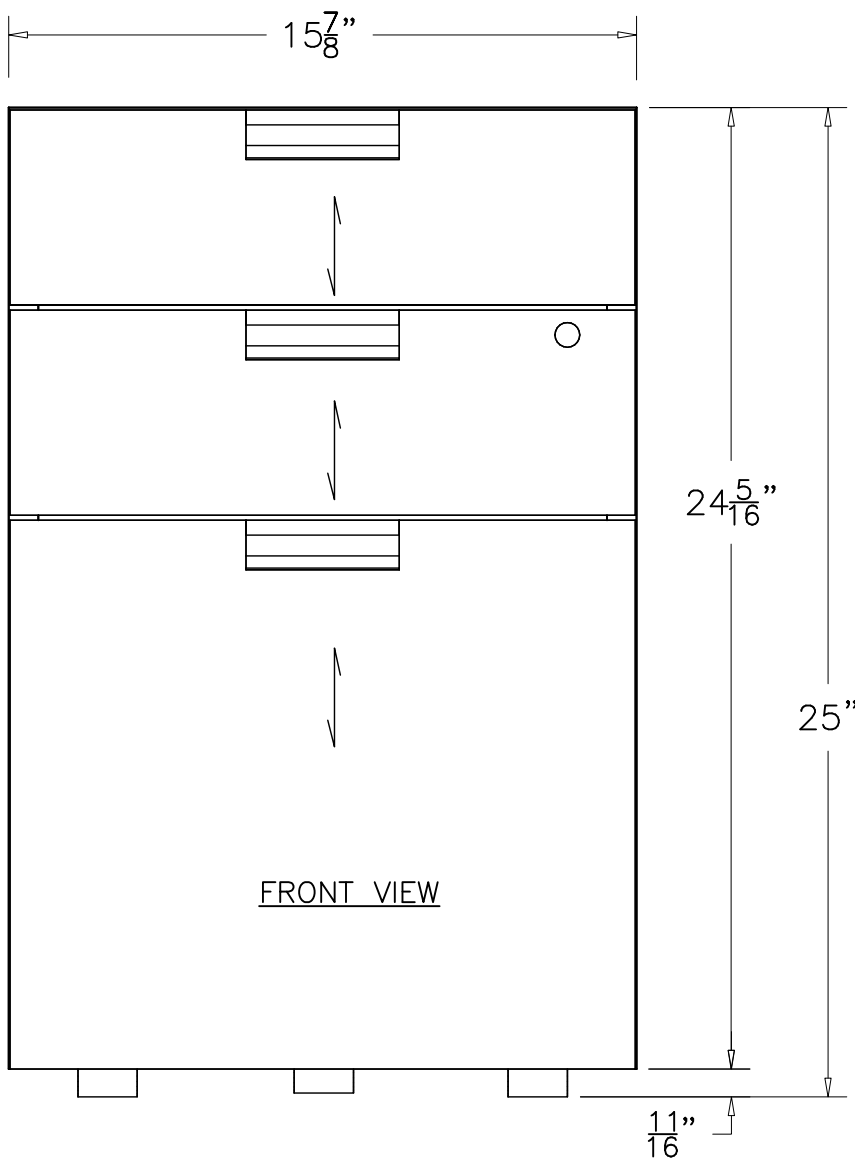

PART # 1625BBF-M	
BODY: PL-2: Arborite #P-623 CA Brushed Al	
FACE: PL-2: Arborite #P-623 CA Brushed Al	
PULLS: 4" FLUSH BRUSHED ALUMINUM	

QUANTITY:	
REVISIONS:	
1	
2	
3	

\* CORPORATE FURNISHING SYSTEMS \*  
\* DESIGN \* ENGINEERING CONSULTANTS \*

**LaCOUR**  
**INC**

36 Kulick Road Fairfield, NJ 07004  
P.973-227-4755, F.973-227-4669

TITLE: 25" MOBILE BOX/BOX/FILE PEDESTAL		DRAWING NO.: CD-16M	
CLIENT:			
APPR. BY:	JOB#:	DATE: Oct. 14, 2014	SCALE NTS

By: David Luis